

1889

MAP OF

Grandview

IN S.E. 1/4 OF S.W. 1/4 OF SECTION 14, T.47 R.33 JACKSON COUNTY, MISSOURI

Scale 1" = 100 ft.

Dec

We James S. Poland and James H. Lewis of County of Jackson State of Missouri, Administrators of the Estate of Grandview in County of Jackson State of Missouri, do hereby certify that said lands laid out and shown on the South East quarter of South East quarter of Section 14, T.47 R.33, and is bounded by lines as follows: Commencing at a corner at the southeast corner of said S.E. 1/4 of S.W. 1/4 of S. 14, west 1299 ft. South 1514 ft. to point of Beginning. That this map is a plan and describes all the lands of ground in that town, dedicated to the public use forever by their boundaries, courses and extent, whether intended for streets, alleys or other public use and their respective land and width. Given under our hands and seals this 7th day of December 1889.

State of Missouri, County of Jackson, Town of Kansas City, on this 7th day of December 1889 before me personally, I see known to be the persons described in and who executed the foregoing instrument and acknowledged the same to me. My Commission as notary public will expire on July 24th 1892.

Thomas H. Wendt

Notary public within & for Jackson County, Mo.

MEASURED BY S.E. 1/4 OF S.W. 1/4 OF SEC. 14

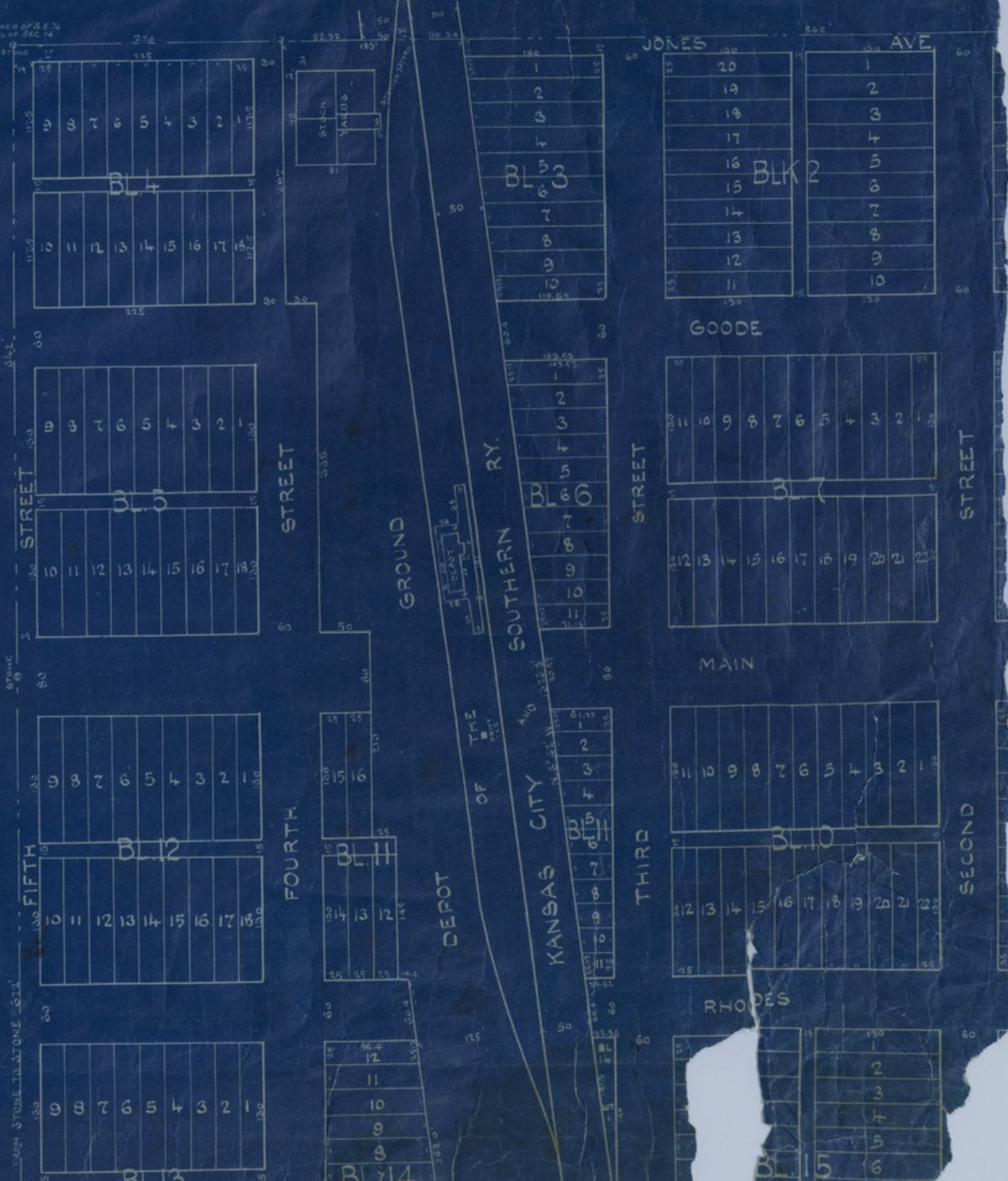

Accession Number M123

Description

A blueprint of an 1889 map of Grandview, Missouri. The map, which was submitted by James G. Feland and James W. Jones, lays out the town by grid blocks. This piece of the map highlights the area from Second to Fifth Street and from Rhodes Avenue to Jones Avenue. The depot ground of the Kansas City Southern Railway is also visible. The other half of this map is missing.

Date(s)

December 14, 1889

Cartographer Submitted by James G. Feland and James W. Jones.

Keywords [Cities and towns](#)

Photo Color Color

Physical Size 19 3/4 X 11 3/4 inches

Related Collection (Plain)

Harry S. Truman Papers Pertaining to Family, Business, and Personal Affairs

Restrictions Unrestricted

Scale 1 inch = 100 feet

TIF Identifier M123.tif

Rights

This item is in the public domain and can be used freely without further permission.

Note: If you use this image, rights assessment and attribution are your responsibility.

Credit: Submitted by James G. Feland and James W. Jones.

Courtesy Harry S. Truman Library & Museum, Independence, Missouri.

Attention media: Please make note of this item's map number. Print out this page and retain it for your permissions records before downloading this image file for possible publication. Library staff cannot sign permissions forms or provide additional paperwork. The Library charges no usage fees for downloaded images. Fees are charged for higher resolution scans.